

## Snatch Block with Shackle Powertex PSBS-S2

### Product information



### POWERTEX

The Powertex PSBS-S2 snatch block with Shackle is a heavy-duty snatch block that can be used for temporary or permanent lifting and pulling installations. The block can be used to redirect a wire rope or to increase the load that the wire rope winch arrangement would be able to handle in a straight loading without block.

The wire rope is easily inserted by removing the hair needle pin, unwinding the quick bolt and turning the side plate.

#### Features:

- Safe - each snatch block is proof load tested 2 x WLL and examined in the factory prior delivery
- Safe - the quick bolt is designed to be positively held in place also when the block is open
- Safe - the swivel assembly is designed to be securely locked also when the block is open
- Durable - forged/machined precision sheaves
- Conical roller bearings (8t and up) or bronze bearings (2t and 4t)
- 2 grease nipples for quick maintenance of moveable parts
- Hot dip galvanized shackle with safety bolt and nut
- Sturdy side plates that protect the moveable parts
- Identification plate made of metal instead of sticker
- RFID equipped (chip) for easy service, inspection and asset control
- Marked with QR code to allow access to user manuals at any time
- 2.2 Test certificate and Declaration of conformity delivered with each block

... [Read more](#)

**Material:** Robust steel construction

**Marking:** CE-marked, UKCA-marked, Powertex, Model, WLL, Manufacturing date and Serial number

**Temperature range:** -20°C up to +50°C

**Finish:** Red painted

**Safety factor:** 5:1

## Snatch Block with Shackle Powertex PSBS-S2

### Blueprint

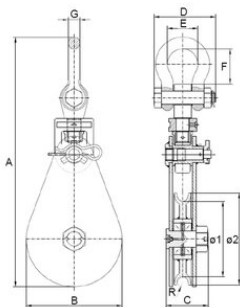

### Technical data

Part code	Code	Rope Ø range mm	WLL ton	Sheave dia mm	Sheave dia. inch	A mm	B mm	C mm	D, mm	E mm	F mm	G, mm	Rmm mm	ø1 mm	ø2 mm	Weight kg
424100200040	PSBS-S2/2T-75-10	7-10	2	75	3	291	82	70	96	43	48.5	16	5,3-5,5	58	75	3.8
424100400040	PSBS-S2/4T-115-13	10-13	4	115	4.5	363	120	70.5	115	58	72	22	6,8-7,15	90	115	6.2
424100400045	PSBS-S2/4T-150-19	16-19	4	150	6	417	160	70.5	115	58	72	22	9,98-10,45	120	150	9.7
424100800040	PSBS-S2/8T-200-22	19-22	8	200	8	527	210	94	133	68	83	25	11,55-12,1	165	200	18.7
424101200040	PSBS-S2/12T-250-26	23-26	12	250	10	679	260	115	166	83	95	32	13,65-14,3	205	250	42.5
424101500040	PSBS-S2/15T-200-24	22-24	15	200	8	665	210	102	193	99	124	38	12,60-13,2	160	200	32
424101500045	PSBS-S2/15T-300-26	23-26	15	300	12	788	310	133	193	99	124	38	13,65-14,3	250	300	57
424102200040	PSBS-S2/22T-350-32	28-32	22	350	14	950	365	140	228	126	157	45	16,8-17,6	295	350	96