

Tongue Shackle - Discontinued

Product information

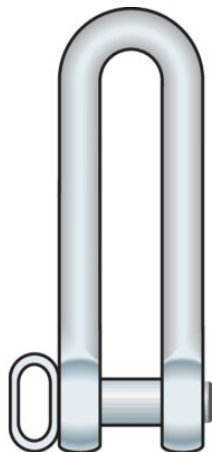

For extracting of steel tongue.

Design: Forged shackle U-bolt extra deep. Screw with big eye for simple handling
... [Read more](#)

Marking: According to standard, CE-marked

Finish: Galvanized

Standard: SMS 1577C, EN 13889

Safety factor: 4.5

Grade: 3

Tongue Shackle - Discontinued

Blueprint

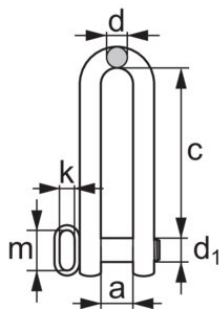

Technical data

Part code	Code	WLL ton	Thread mm	A mm	c* mm	D mm	k mm	m mm	Weight kg
420100900110	SPONT.9	9	M39	48	370	32	50	100	8.3