

Connection link, grade 80

Product information



Connecting link is used for connecting short link grade 80 chains to different components in a lifting sling.

... [Read more](#)

Material: Steel

Marking: According to standard, CE-marked

Temperature range: -40 - (+)200°C / 400°C = WLL 75%

Finish: Painted, yellow

Standard: EN 1677-1

Warning: Not to be heat-treated

Safety factor: 4:1

Grade: 8

Connection link, grade 80

Blueprint

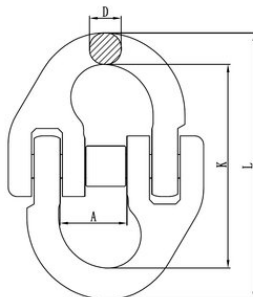

Technical data

Part code	WLL ton	EWL mm	For chain Ø mm	A mm	D mm	K mm	L mm	S mm	Weight kg
4012LL6	1.12	42	6	15	7,5	46	61	-	0.08
4012LL78	2	60	7-8	19	8,5	59	77	-	0.146
4012LL10	3.15	68	10	25	12	69,5	96,5	-	0.3
4012LL13	5.3	87	13	30,5	-	90	122,5	16	0.65
4012LL16	8	108	16	36	19	101,5	141,5	-	1.15
4012LL20	12.5	121	20	42	23	119	165,5	-	2.1
4012LL22	15	141	22	49	24,5	152	206,5	-	2.87
4012LL26	21.2	158	26	58,5	31,5	162	225,5	-	4.5
4012LL32	31.5	205	32	67,5	38,5	194	272	-	8.21